

**Panel høyde
200-595 mm:**

Skruefeste gjennomgående mellom begge plater.

**Panel høyde
196 mm:**

Skruefeste i overkant underliggende panel.

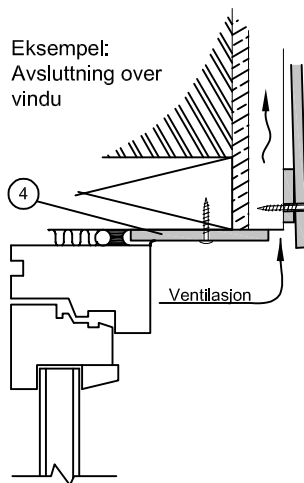
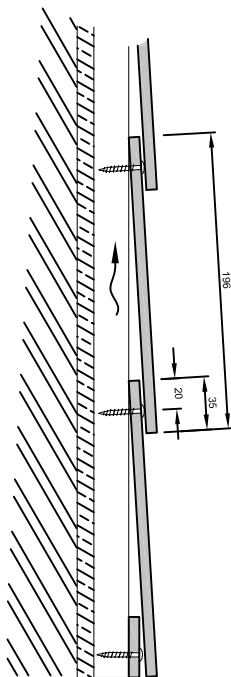

Eksempel:
Utvendig hjørne m/
hjørneelement

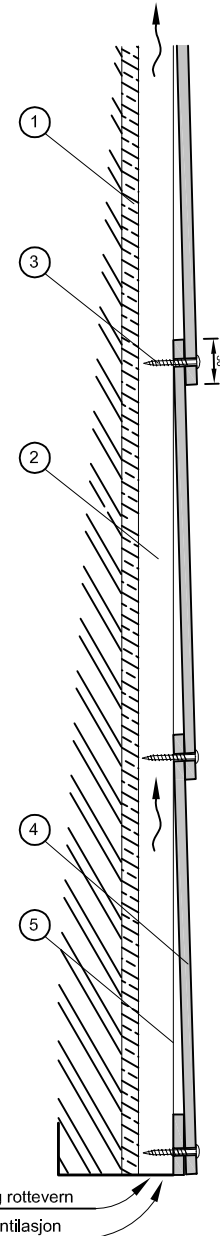
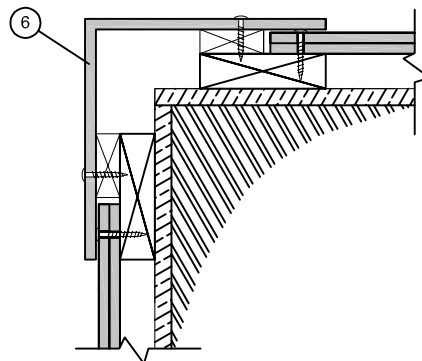

- ① Vindsperre
- ②a Trelekte impregneret T18 - 28x95
- ②b Trelekte impregneret T18 - 28x70
- ③ Rustfri skrue A4 : 4x33 mm
- ④ Steni Colour alt. Steni Nature Fine micro
- ⑤ EPDM folie
- ⑥ Steni hjørneelement

T:\03_Detaljtegninger\FS detaljer\DWG\FS200_NO_02052016.dwg.

FS 200_1

Oppriss og detaljer

Issued by/Tegnet av:
JMK

Date of issue/Tegnet dato:
02.05.2016

Scale/Målestokk:
1:5



steni as
Tlf.: +47 3315600
www.steni.com